

Fittings for welding DIN 11852

Art.No EUR Art.No EUR

Bend 90° DIN 11852, long

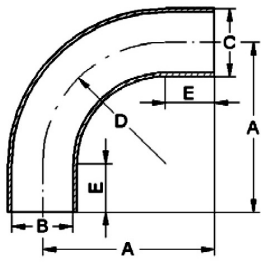

DN	A	B	C	D	E	AISI304		AISI316L-1.4404	
10	51	10	13	26	25	560930	Enquiry	561030	Enquiry
15	60	16	19	35	25	560931	Enquiry	561031	Enquiry
20	65	20	23	40	25	560932	Enquiry	561032	Enquiry
25	90	26	29	50	40	560933	Enquiry	561033	Enquiry
32	95	32	35	55	40	560934	Enquiry	561034	Enquiry
40	100	38	41	60	40	560935	Enquiry	561035	Enquiry
50	110	50	53	70	40	560936	Enquiry	561036	Enquiry
65	120	66	70	80	40	560937	Enquiry	561037	Enquiry
80	145	81	85	90	55	560938	Enquiry	561038	Enquiry
100	155	100	104	100	55	560939	Enquiry	561039	Enquiry
125	245	125	129	187,5	57,5	560941	Enquiry	561041	Enquiry

Bend 90° DIN 11852 BA5

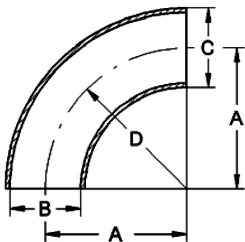

DN	A	B	C	D	AISI304		AISI316L-1.4404	
10	35	10	13	40	562930	Enquiry	563030	Enquiry
15	50	16	19	50	562931	Enquiry	563031	Enquiry
20	55	20	23	55	562932	Enquiry	563032	Enquiry
25	65	26	29	65	562933	Enquiry	563033	Enquiry
32	75	32	35	75	562934	Enquiry	563034	Enquiry
40	95	38	41	95	562935	Enquiry		
50	125	50	53	125	562936	Enquiry	563036	Enquiry
65	160	66	70	160	532937	Enquiry	533037	Enquiry
80	200	81	85	200	532938	Enquiry	533038	Enquiry
100	250	100	104	250	532939	Enquiry	533039	Enquiry
125	312,5	125	129	312,5	532941	Enquiry	533041	Enquiry
150	375	150	154	375	532942	Enquiry	533042	Enquiry
40	95	38	41	125			563035	Enquiry

Bend 180° DIN 11852

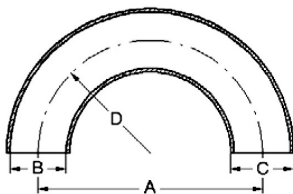

DN	A	B	C	D	AISI304		AISI316L-1.4404	
10	52	10	13	26	562330	Enquiry	562430	36,80
15	68	16	19	35	562331	38,90	562431	41,10
20	76	20	23	40	562332	42,50	562432	44,70
25	100	26	29	50	562333	39,20	562433	46,90
32	110	32	35	55	562334	47,70	562434	54,50
40	120	38	41	60	562335	51,30	562435	61,20
50	140	50	53	70	562336	62,50	562436	75,80
65	160	66	70	80	533537	83,80	533637	97,20
80	180	81	85	90	533538	111,90	533638	132,90
100	200	100	104	100	533539	131,20	533639	159,40